

BONUS MAGAZINE! FLIP TO SEE 2020'S TOP TRENDING LOOKS



AUSTRALIAN

home beautiful

SIX AMAZING AUSTRALIAN HOMES

ESCAPE TO THE

coast

Why you need A SMART BATHROOM

BRING THE SEASIDE HOME WITH *relaxed decorating* & EASY LIVING

KITCHEN COOL A BUYER'S GUIDE TO FRIDGES + FREEZERS

LIGHT HOUSE Bright ideas for outdoor soirees

2020 STYLE FORECAST

Fall in love with four breathtaking new trends

ARCHITECTURE

OPEN HOUSE

THE SEAMLESS CONNECTION BETWEEN INDOOR AND OUTDOOR SPACES IS JUST ONE OF THE STUNNING FEATURES OF 'THE BIRD HOUSE' ON QUEENSLAND'S GOLD COAST

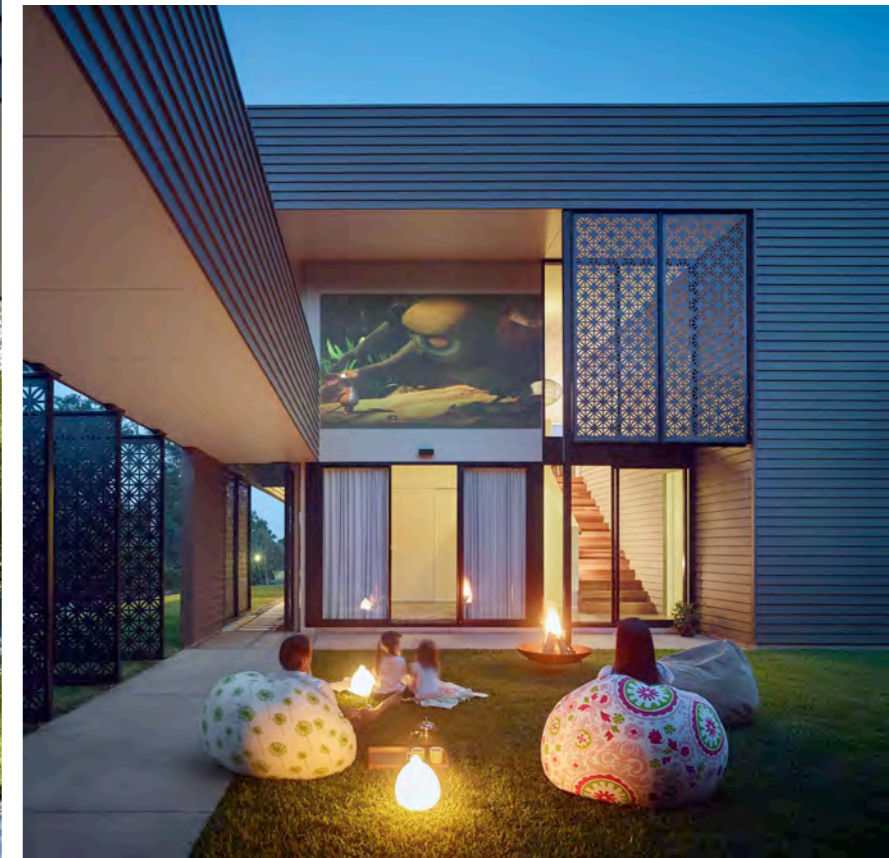

When architects Angela and Mark Jamison, from Jamison Architects, set about designing their dream family home and studio, their brief-to-self was to create a home that was an experimental example of how architecture can affordably enhance one's wellbeing and lifestyle. The result is The Bird House. A stunning example of the Mid Century Modern look, the house's bushland setting provides a strong connection with nature. The flat style of roof and seamless indoor/outdoor flow are also hallmarks of the look, along with its light-filled open plan living. Smart design captures natural cross-ventilation, negating the need for air conditioning. The home is comprised of two pavilions connected by a central grassed courtyard, surrounded by openable laser-cut screens that provide a unique entry. The courtyard changes dimension depending on the time of day. By day it offers shade and filtered light through the screens; by night it becomes a

beautiful, private outdoor room under the stars where the family spend time together toasting marshmallows around the fire bowl. The use of clever, affordable materials throughout the house is one of its many practical, yet aesthetic, features. The laser-cut screens are used in other areas of the home to provide shade, privacy and separation of space. The house has an extremely efficient plan and the illusion of space is maximised through the use of a void and floor to ceiling glass that gives even greater connection to the environment. The use of James Hardie Linea Weatherboards for the exterior cladding flows from the courtyard wall to the entry of the main pavilion, drawing people upstairs to the open plan living area with its spectacular views. For Angela and Mark, The Bird House is a triumph, both personally and professionally. Through cost effective materials and construction methods they created a unique family home that responds to its place and is a pleasure to live in.

CREATE SHARP EXTERIOR LOOKS

THE CRISP LINES OF JAMES HARDIE'S 16MM LINEA DEEP-SHADOW FIBRE CEMENT WEATHERBOARDS ALLOWED FOR A SEAMLESS INDOOR/OUTDOOR DESIGN FLOW THAT'S AS PRACTICAL AS IT IS AESTHETICALLY PLEASING.

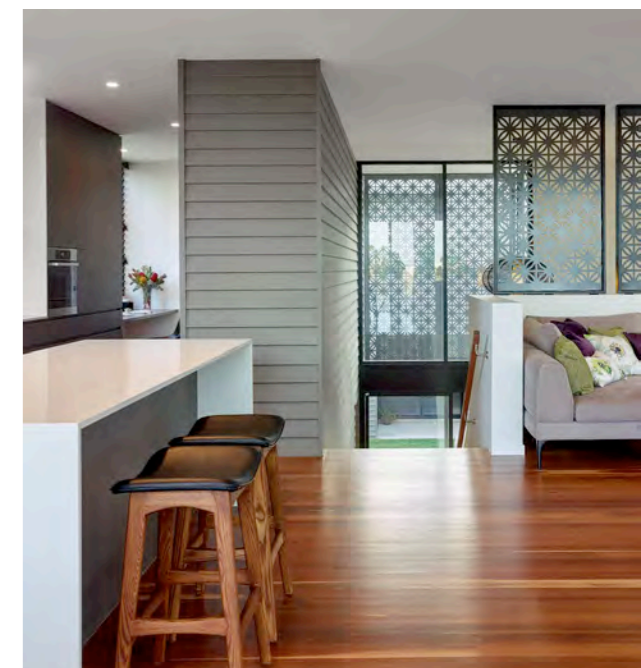

FOR MORE INFORMATION VISIT JAMESHARDIE.COM.AU/LOOKS/MODERN

 **JamesHardie™**